

Safety notes:
 Installation should be performed only by qualified electrician.

- Make sure no voltage while installation.
- Connect cable wires according to wire labeling.
- Max current should not exceed 16A in one power feed in circuit.

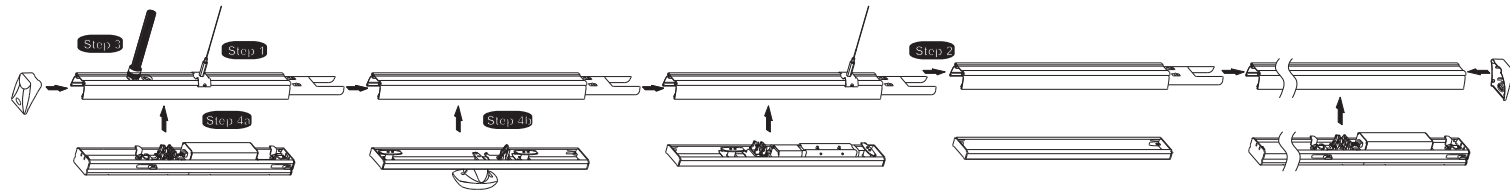

Step 1
Mounting Suspension
 Drill a hole on ceiling

Fix mounting hook into ceiling

Adjust length of suspension cord:
 a. press down Hexagon bolt;
 b. Pull in/out cord to adjust length

Click in mounting clip into trunking rail

Step 2
Connecting Trunking Rail
 Both trunking rails should keep in perfect position then push to click

How to dispatch the connected trunking rails in case of misoperation

To separate both trunking rails screw off the rail connecting screws then pull apart

Step 3
Connecting Power Supply

Cut the Rubber cap to pass the power cable

Screw in the conduit gland

Put in conduit with cable inside and pull up conduit gland to lock

Connect wires according labeling on wires to feed in connector then connect to connector in trunking rail

Step 3
Mounting Luminaire

Slide knob to select phase L1/L2/L3

Make sure male & female connectors in right position then fix the luminaire to trunking rail

Push the sliding lock to lock the luminaire to trunking rail

Cover with protection cap

Step 4b
Mounting Sensor Module
 2 options: Motion Sensor
 Daylight Sensor

Dial switch to set sensor index. For details, please refer to sensor setting data sheet

Click in and connect cable to corresponding cable connector

Select phase to control corresponding dimming lights L1/L2/L3

Rotate the knob to horizontal direction and press down to lock

Twist sensor head to adjust angle

Five options for power feed in



Terminal feed in trunking rail

Connect the feed in pin connector to truck rail wires connector then connect power feed in cable accordingly to feed in pin connector

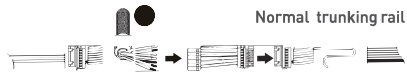

Normal trunking rail

Unscrew the connector in the trunking rail then fold wires backward to keep distances from power feed in hole as above picture in box, then connect the power cable wires accordingly to feed in pin connector

Central power feed in trunking rail



Connect the power feed in cable from central hole of trunking rail if there are two feed out connectors on both sides of trunking rail

Power feed in box

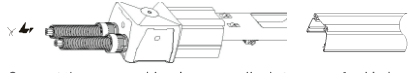

Connect the power cable wires accordingly to power feed in box then push to trunking rail to click

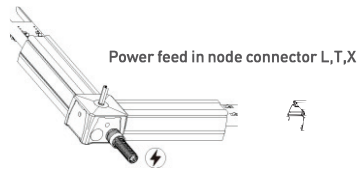

Power feed in node connector L,T,X

Using power feed in node connectors connect power cable wires accordingly to node connectors then push trunking rail or node connectors to click

Wire diagram of Triple Circuits function

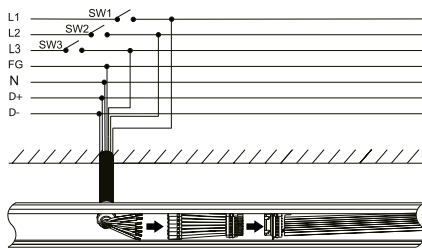

This Triple Circuits function offers to control lighting ON/OFF by three switches SW1, SW2, SW3 which are connected by live lines L1, L2, L3

Remarks:

First trunking rail should have one side connecting plate & last trunking rail with no connecting plate on both sides, then fix the Luminaire to trunking rail then slide the locks, cover with protection caps, then keep end caps at both sides

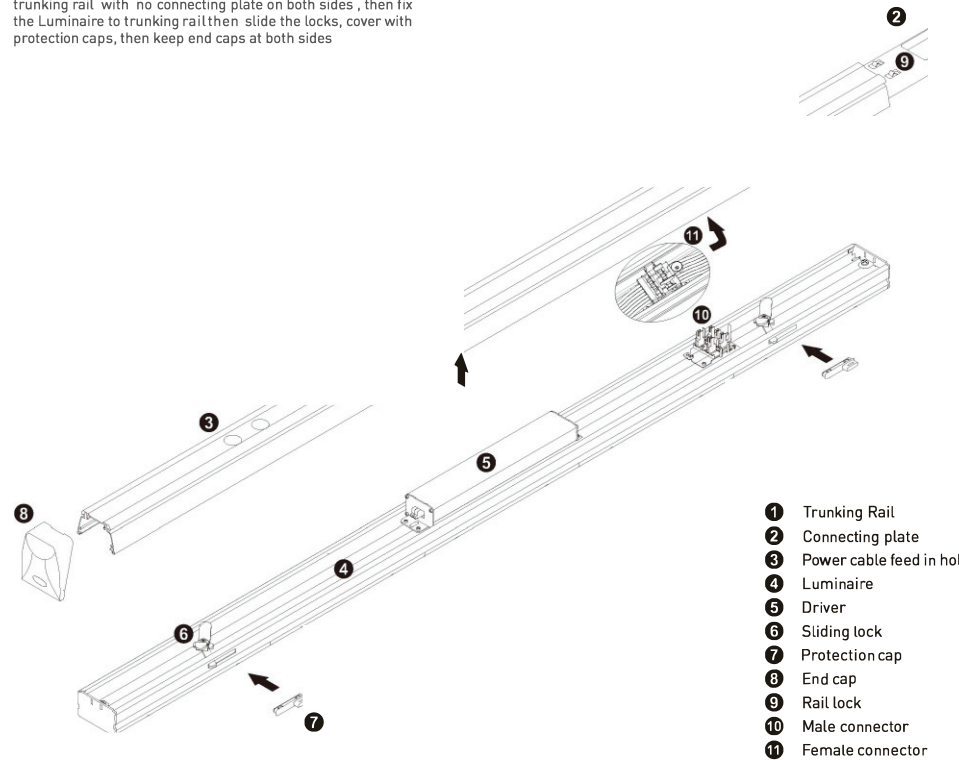

- 1 Trunking Rail
- 2 Connecting plate
- 3 Power cable feed in hole
- 4 Luminaire
- 5 Driver
- 6 Sliding lock
- 7 Protection cap
- 8 End cap
- 9 Rail lock
- 10 Male connector
- 11 Female connector

Pendant and mounting installation

Starting Installation distances point should be 800 mm to 1000 mm, then in between 1st & 2nd point should be 3000 mm max

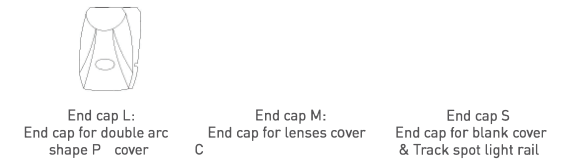

Emergency luminaire

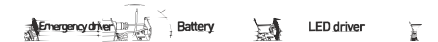

- Wire to battery is disconnected during shipment. Reconnect it before installation
- Keep batteries away from direct sunlight, high temperature and high humidity.
- During long terms of storage, battery should be recharged at least once time a month for longer life time of battery

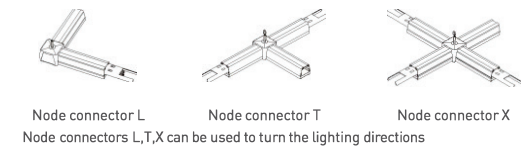

Four options for installation

